

# K20

## ESPECIFICACIONES FEATURES

|   |  |
|---|--|
| Tipo de instalación<br><i>Type of installation</i>                  | Embutir (Lector)<br><i>Flush (Reader)</i>        |
| Diametro (Lector)<br><i>Diameter (Reader)</i>                       | 40 mm  |
| Profundo (Lector)<br><i>Depth (Reader)</i>                          | 29 mm  |
| Frecuencia<br><i>Frequency</i>                                      | MF-13,56 Mhz                                     |
| Instalación exterior (IP)<br><i>Exterior installation (IP)</i>      | Sí (IP54 - Lector)<br><i>Yes (IP54 - Reader)</i> |
| Protección antivandálica<br><i>Anti-Vandalism Protection</i>        | No<br><i>No</i>                                  |
| Alimentación eléctrica<br><i>Power Supply</i>                       | 12 VDC   |
| Consumo corriente en reposo<br><i>Current consumption in idle</i>   | ≤ 50 mA  |
| Consumo corriente en activo<br><i>Current consumption in active</i> | ≤ 300 mA   |
| Salida puerta<br><i>Port output</i>                                 | 5A (NO/NC)                                       |

## FUNCIONES FUNCTIONS

|  |  |
|--|--|
| Capacidad<br><i>Capacity</i>                 | Usuarios ilimitados<br><i>Unlimited users</i>      |
| Red<br><i>Network</i>                        | 4G (SIM integrada)<br><i>4G (SIM incorporated)</i> |
| Gestión de grupos<br><i>Group management</i> | Sí<br><i>Yes</i>                                   |
| Horarios<br><i>Schedules</i>                 | Sí<br><i>Yes</i>                                   |
| Registro de accesos<br><i>Access records</i> | Sí<br><i>Yes</i>                                   |

## PLANO TÉCNICO TECHNICAL DRAW

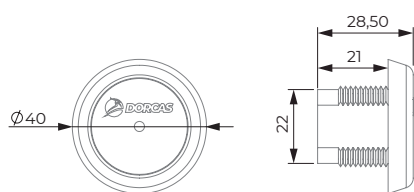

LECTOR  
READER

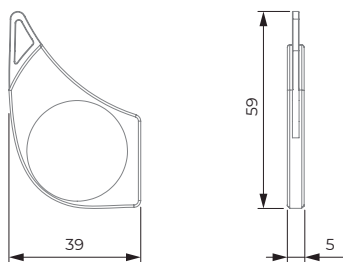

LLAVE DE PROXIMIDAD  
PROXIMITY BADGE

AUTENTICACIÓN MEDIANTE LLAVE  
AUTHENTICATION BY BADGE



AMAESTRAMIENTO DIGITAL  
DIGITAL MASTER KEYING

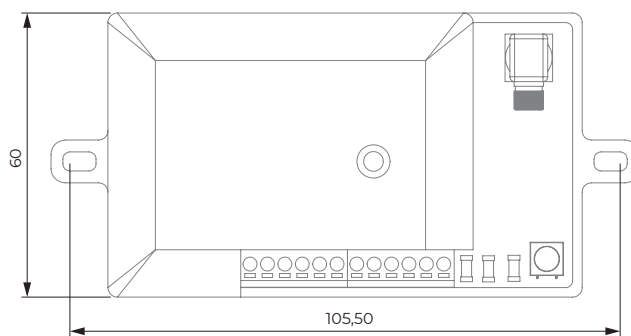
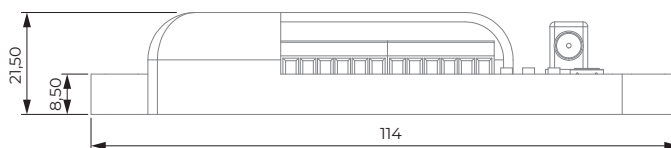

CENTRALITA  
CENTRALITE

